



Innsbrook Traditional & Loft Contemporary Direct-Vent Fireplace Insert Systems

Innsbrook 35,000 Btu Direct-Vent Fireplace Insert shown with optional Contemporary Style metal surround.



White Mountain Hearth – The Pinnacle of Efficiency



Innsbrook Traditional & Loft Contemporary

A Direct-Vent Fireplace Insert turns your existing wood-burning fireplace into an efficient gas-fired heat source.

A wood-burning fireplace sends more than half of its heat up the flue, creating negative pressure in your home, which draws in outside air through gaps in doors and windows that actually makes your home colder. A wood-fire can also create ash and fumes that dirty your home and aggravate your allergies.

Direct-Vent Fireplace Inserts are classified as zone heating appliances. Zone heating is inherently more efficient than your existing wood-burning fireplace or your central furnace. Unlike a central furnace, which wastes 20 to 30 percent of the heat energy through ductwork losses and sends much of the remaining heat to unoccupied rooms, zone heating creates and transmits the heat directly into the room. This lets you turn down your whole-house thermostat and use your fireplace insert to efficiently warm the room you use most.

Our Direct-Vent insert uses readily available 3-inch flexible co-linear vent pipes. One draws air from outside your home, and the other sends flue products directly outdoors. The flexible metal venting allows the insert to install easily in a site-built or manufactured fireplace.

Direct-Vent systems eliminate pressure imbalances in the home that can cause drafts that reduce the effectiveness of heating. At up to 77% AFUE, a traditional or contemporary Direct-Vent Insert makes a great heat source for any room in your home.

Features

Standard Features

We offer our traditional Innsbrook Direct-Vent Inserts in three sizes – small, medium, and large – to fit most wood-burning fireplaces. Our traditional inserts feature reliable Millivolt ignition with standing pilot to provide heat, even in the absence of electric power.

Our Innsbrook Direct-Vent inserts feature Banded Brick Liners, hand-painted ceramic fiber logs, nestled atop the variable flame height burner, to create an exceptionally attractive traditional fireplace. With inputs of 25,000 Btu, 33,000 Btu, and 35,000 Btu, the Direct-Vent insert's unique stainless steel Slope Glaze Flair Burner produces natural flickering flames that dance and delight – warming your heart as it warms your soles.

Awaken your inner artist with a Loft Series Contemporary Direct-Vent Insert – in small (20,000 Btu) or medium (27,000 Btu). Choose Millivolt ignition or our Green Earth Preferred Intermittent Pilot system which eliminates the standing pilot for even greater energy savings. IP system include a remote control to light your fireplace insert at the push of a button.

The black porcelain-lining inside the Loft insert reflects the mesmerizing flame from the contemporary linear burner to create depth and visual interest from any angle.

All metal construction delivers outstanding durability.



Options & Accessories

Your new direct-vent insert will require a surround kit to conceal the original fireplace opening. For Innsbrook traditional models, choose an old-world style three-piece cast iron surround with rich details at the corners, keystone, and columns, or one of our steel surrounds with either 6-inch top and side panels or 6-inch top and 3-inch side panels.

For installations where your Innsbrook insert does not rest on the hearth, we offer a 1 5/16-inch bottom cover to complete the surround.

To cover larger hearth openings, install the optional shroud. At 48 inches wide and just under 38 inches tall, it provides a clean transition between the surround and the existing fireplace. The 2-inch bottom cover completes the shroud.

For the Loft DV Insert, choose a matching contemporary surround in all black or in black and stainless steel. The bold stainless steel panels top and bottom accentuate the clean horizontal look of the Loft Insert.



Optional Cast Iron Surround shown with 33,000 Btu Innsbrook Direct-Vent unit



6 x 6-inch Contemporary Style metal surround shown with 33,000 Btu Innsbrook Direct-Vent unit



6 x 3-inch Contemporary Style metal surround with 33,000 Btu Innsbrook Direct-Vent unit



6 x 3-inch Contemporary Style metal surround and Universal Shroud shown with 33,000 Btu Innsbrook Direct-Vent unit

Complete your Loft insert with decorative glass – available in Black Polished, Blue Clear, and Clear Frost. Additional colors are available through your local hearth dealer.



Loft Series insert with surround in Matte Black.



Loft Series insert with surround in Matte Black and Stainless Steel.



Decorative Glass for the Loft Series fireplace can be placed on the floor of the firebox and is available in Blue Clear, Clear Frost, and Polished Black.

Options & Accessories



Loft 33,000 Btu Direct-Vent Fireplace Insert shown with Polished Black Decorative Glass and Matte Black metal surround.

Surround and Shroud Dimensions

Model	Description	Surround Color	A	B	C	D	E	F	Fits Models
S256BL	6 x 6-inch Metal Surround	Matte Black	25 5/8	40	1 1/2	19 5/8	28	6	DV25IN
S336BL	6 x 6-inch Metal Surround	Matte Black	28 5/8	43	1 1/2	22 5/8	31	6	DV33IN
S356BL	6 x 6-inch Metal Surround	Matte Black	30 5/8	46	1 1/2	24 5/8	34	6	DV35IN
S253BL	6 x 3-inch Metal Surround	Matte Black	25 5/8	34	1 1/2	19 5/8	28	6	DV25IN
S333BL	6 x 3-inch Metal Surround	Matte Black	28 5/8	37	1 1/2	22 5/8	31	6	DV33IN
S353BL	6 x 3-inch Metal Surround	Matte Black	30 5/8	40	1 1/2	24 5/8	34	6	DV35IN
SC256BL	6 x 6-inch Cast Iron Surround	Matte Black	26 7/8	39 7/8	2 1/4	19 7/8	28	7	DV25IN
SC336BL	6 x 6-inch Cast Iron Surround	Matte Black	29 7/8	42 7/8	2 1/4	22 7/8	31	7	DV33IN
SC356BL	6 x 6-inch Cast Iron Surround	Matte Black	31 7/8	45 7/8	2 1/4	24 7/8	34	7	DV35IN
SH1BL	Universal Shroud	Matte Black	37 13/16	48	1/2	23 13/16	36	12	Fits all surrounds except S253BL
S2562BL	6 x 6 x 2 4-Sided Metal Surround	Matte Black	22 1/4	40	2 1/4	14 1/8	27 7/8	6	DVL25IN
S2562BLSS	6 x 6 x 2 4-Sided Metal Surround	Matte Black & Stainless Steel	22 1/4	40	2 1/4	14 1/8	27 7/8	6	DVL25IN
S3362BL	6 x 6 x 2 4-Sided Metal Surround	Matte Black	25 1/4	43	2 1/4	17 1/8	30 7/8	6	DVL33IN
S3362BLSS	6 x 6 x 2 4-Sided Metal Surround	Matte Black & Stainless Steel	25 1/4	43	2 1/4	17 1/8	30 7/8	6	DVL33IN

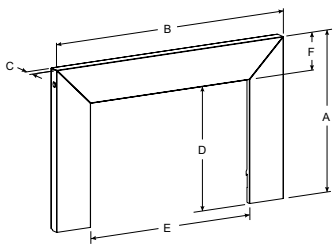

6 x 6-inch
Metal Surround

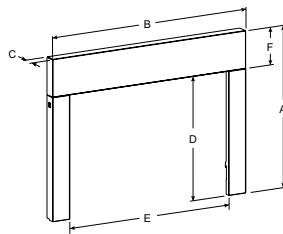

6 x 3-inch
Metal Surround

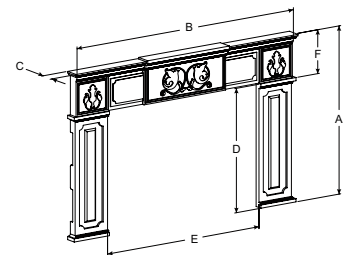

6 x 6-inch
Cast Iron Surround

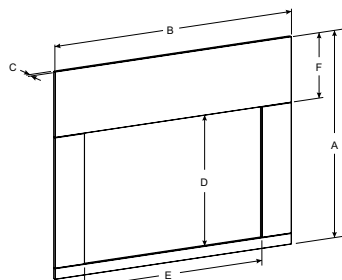

Universal Shroud
(with bottom cover)

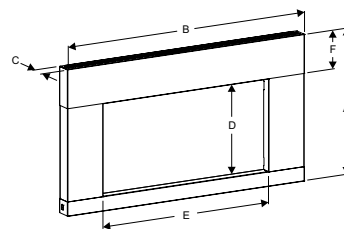

6 x 6 x 2-inch
4-Sided Metal Surround



Innsbrook 33,000 Btu Traditional Direct-Vent Fireplace Insert shown with optional three-inch metal surround and Universal Metal Shroud.

Control Options for Millivolt Direct-Vent Inserts

Lighting and managing a wood fire takes time and work – and more than a little patience to get it right. Your Innsbrook or Loft fireplace insert lights at the flick of a switch to produce consistent, reliable heat, even when electric power fails. Add the convenience of an optional thermostat, wireless wall thermostat, remote control, or thermostat remote control, and enjoy all the comfort of a warm cozy fire without the mess and hassle.



*FRBC
Remote*



*FREC
Electric Remote Control*



*FRBTC
Thermostat Remote Control*



*FRBTP
Programmable Remote Control*



*FWS
Wall Switch*



*TRW Wireless
Wall Thermostat*



*TMV
Wall Thermostat*

Decorative Louvers for Traditional Direct-Vent Inserts

With four styles and four finishes from which to choose, our decorative louvers help create the perfect look for your Innsbrook traditional fireplace insert.

Finishes include our rich matte black, contemporary hammered pewter, traditional polished brass, and modern stainless steel.

In addition to the traditional slat louvers, we offer a graceful Arched pattern, a geometric Mission pattern, and an elegant Leaf pattern.

All of our decorative louvers install in seconds without tools.



Decorative Louver Arch



Decorative Louver Leaf



Decorative Louver Mission

Traditional Direct-Vent Insert Dimensions

Model	A	B	C	D	E	F	G	H	I	J	K	L	M	N
DV25IN	19 3/4	28	14 1/2	11 1/8	25 1/4	12 3/4	17	18 5/16	27	6 3/4	9	20	25 5/8	40
DV33IN	22 3/4	31	16	14 1/8	28 1/4	14 1/4	18 3/4	21 5/16	30	8 1/4	10 1/2	21 1/2	28 5/8	43
DV35IN	24 3/4	34	16	16 1/8	31 1/4	14 1/4	21 3/4	23 5/16	33	8 1/4	10 1/2	23	30 5/8	46

* Note: Illustrations shown are based on Direct-Vent models with 6 x 6-inch metal surround.

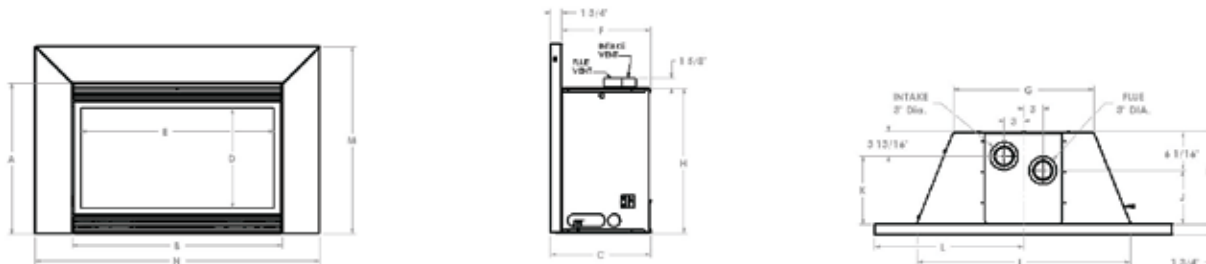

Loft Direct-Vent Insert Dimensions

Model	A	B	C	D	E	F	G	H	I	J	K	L	M	N
DVL25IN	16 1/4	28	15 1/4	10 7/16	25 1/4	12 3/4	17	18 5/16	27	6 11/16	8 13/16	20	22 1/2	40
DVL33IN	19 1/4	31	16 3/4	13 7/16	28 1/4	14 1/4	18 3/4	21 5/16	30	8 3/16	10 7/16	21 1/2	25 1/2	43

* Note: Illustrations shown are based on Direct-Vent models with 6 x 6 x 2-inch metal surround.

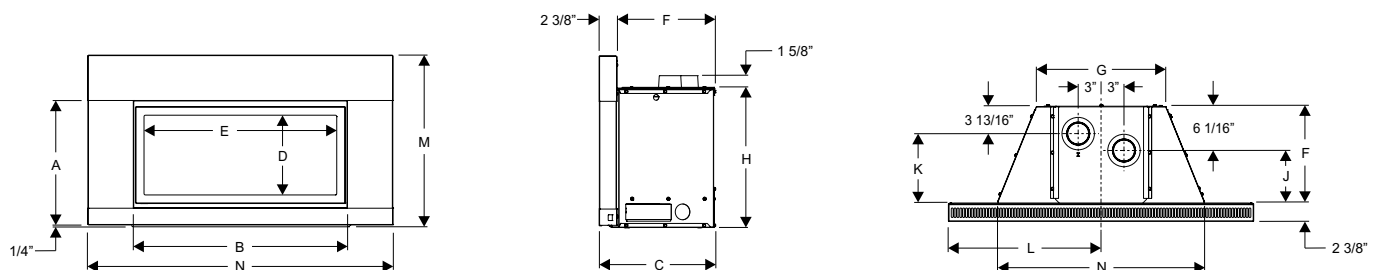

Minimum Fireplace Opening Dimensions

Model	A	B	C	D
DV25IN	18 3/8	27 1/2	12 3/4	17 1/4
DV33IN	21 3/8	30 1/2	14 1/4	19
DV35IN	23 3/8	33 1/2	14 1/4	22
DVL25IN	18 3/8	27 1/2	12 3/4	17 1/4
DVL33IN	21 3/8	30 1/2	14 1/4	19

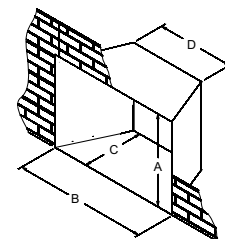

* Note: On Direct-Vent installations, if the fireplace lintel is wider than 8" (203 mm), the height of the fireplace opening must be increased a few inches to allow for a gradual offset in the exhaust and/or intake vent pipes.

Gas Inlet		Warranty
Type of Gas (State on Order)	Natural or LP	All vented parts carry a 3-year limited warranty.
Iron Pipe Size (N.P.T.)	1/2 inch	
Ignition Systems	Standing Pilot/Piezo or IP (DVL)	

Empire Comfort Systems Inc., has manufactured safe, reliable heating systems for almost 80 years. We take pride in our reputation for quality products, backed by the best sales, service, and distribution network in this industry. These fireplaces combine proven technologies with exceptional artistry and craftsmanship to add beauty and warmth to any home.

Member of the following industry associations:



This appliance is design-certified to the ANSI standard by:



SINCE 1932

Empire Comfort Systems Inc.
918 Freeburg Ave.
Belleville, IL 62220-2623
info@empirecomfort.com

WMH-00769 4/1/11

The Empire Comfort Systems and White Mountain Hearth names and logos are registered U.S. trademarks.